

# Dig Plan 10m x 5.5m - Wall height 1.32m

All measurements are in millimeters unless otherwise stated.

## GROUND PREPARATION

The preparation of the ground is a very important step in the installation of your Pool.

**EXCAVATED PAD MUST BE LEVEL & COMPACTED TO 100 Kpa**

- Have a helper hold a tape measure or string line and mark the Pool perimeter with flour or chalk powder, or peg it out with stakes.
- Remember the bottom rail and the wall sits on natural ground not sand. It is the most important that if posts are not on natural ground that paving blocks be used to build up from the natural ground level to the base of the bottom rail, this being flush with the ground surface.
- Brickies loam is placed inside the frame work & Pool wall to cushion the liner on the base of the Pool. A thickness of 50mm to 75mm is recommended on the floor increasing to 200mm to 300mm where the floor meets the wall to create a cove. This cove is important to insure your liner fits correctly.

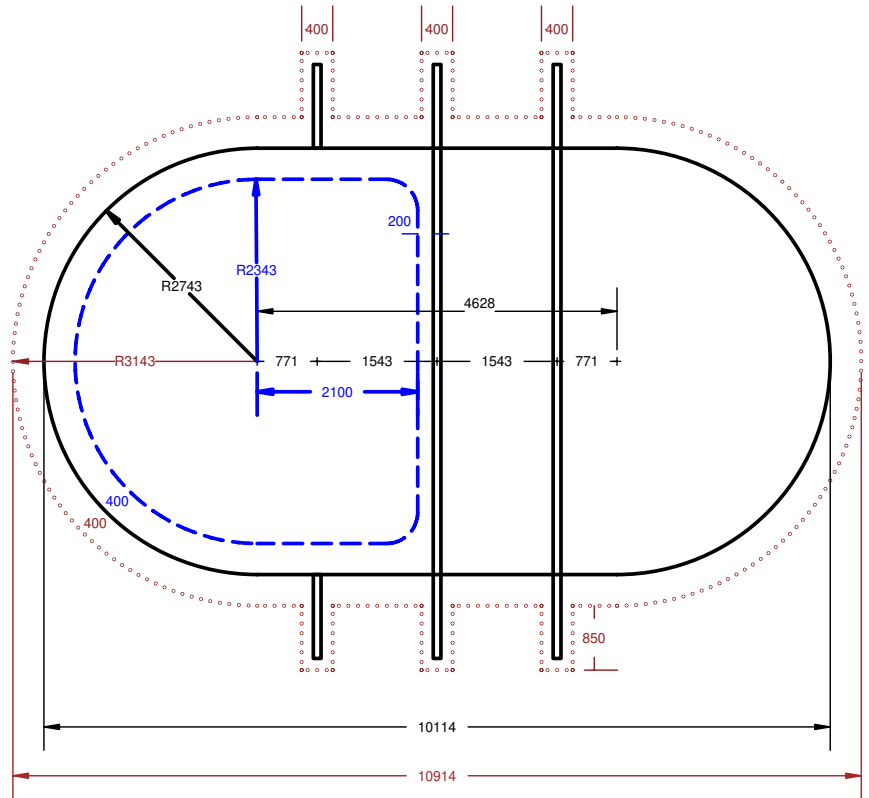

Back fill with 6 Parts Course Bedding Sand To 1 Part Cement.

Back fill must fall away from the Pool to avoid water buildup around edges of the Pool

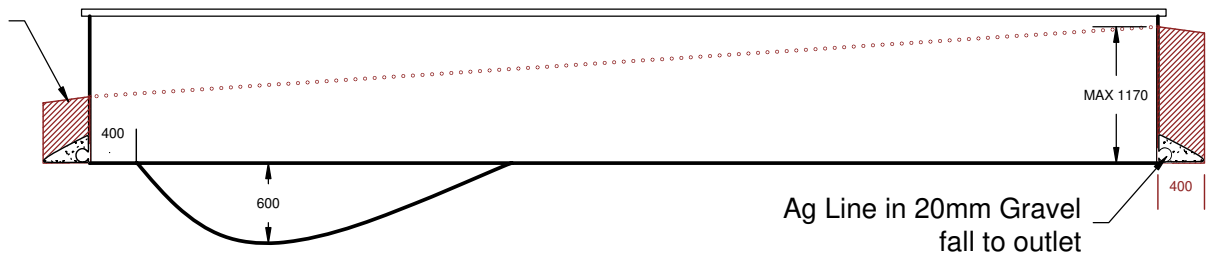

**BRICKIES LOAM REQUIRED**  
 Flat Bottom Pools 5 Cubic Metres  
 Deep End Pools 5.5 Cubic Metres  
 1 Bag Cement

